



## Zigbee 3.0 Wired Gateway

Model No.: ZB-Box2

### 1. Features

The product follows the standard protocol of Zigbee 3.0. Zigbee device connect with network based on this gateway and communicate with other device. Zigbee gateway connect with router via network cable to achieve communication between icloud and smartphone APP. Through the **[MiBoxer Smart] APP**, user can add zigbee device, group control, remote control, third party voice control and smart ambient lighting.

- Zigbee 3.0 standard protocol
- Timing setting
- Support zigbee 3.0 product series
- Do not disturb mode
- Support smartphone APP control
- Sleep/ wakeup plan
- Support music rhythm
- Biorhythm
- Support third party voice control
- Tap-to-Run & automation
- Scene customization
- Device sharing
- Support long-range control

### 2. Parameters

Model No.: ZB-Box2  
 Input: DC5V / 1A (Micro USB)  
 Working Temperature: -10~40°C  
 Wireless Technology: Zigbee 802.15.4  
 Zigbee Transmitting Power: 10dBm  
 Max Connected Device: 128  
 Zigbee Control Distance: 100m (open area)

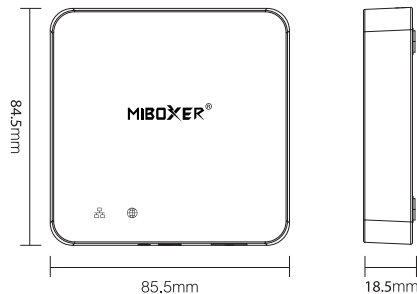

### 3. Device Installation

Connect gateway with power supply and make connection with home router.

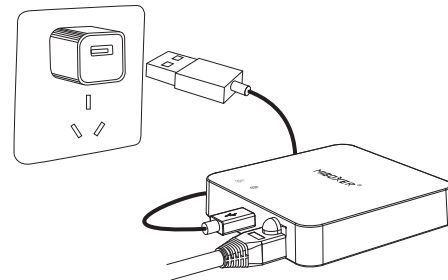

#### Indicator status description

| Equipment status               | Indicator | Indicator |
|--------------------------------|-----------|-----------|
| Pairing network                | Always ON | Always ON |
| Connected successfully         | OFF       | Always ON |
| Add zigbee device into network | Flashing  | Always ON |
| Network disconnection          | OFF       | OFF       |

### 4. APP Installation

#### 4.1. Download and install [MiBoxer Smart] APP

Search for **[MiBoxer Smart]** in Apple or Google store or scan following QR code to download and install the app.



Please click "Register" button to create account while using it in the first time, Log in directly if you already had account.

4.2. Smartphone connect with home wifi router ( Note: Ensure your smartphone and gateway in the same network)

### 5. Network Configuration

5.1. Connect gateway with power supply and make connection with home router.

5.2. Ensure two indicators always on.  
 (Please long press "Reset" button 5 seconds if two indicators is not always on).

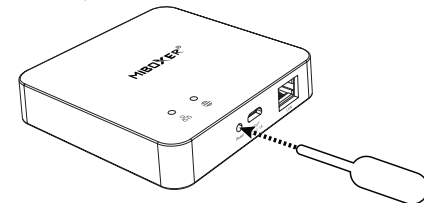

5.3. Open APP homepage and click add button "+" in the upper right corner

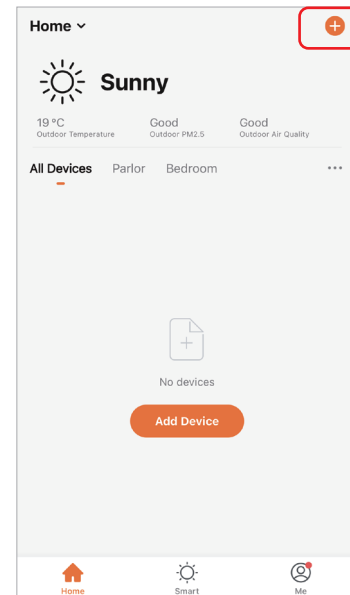

5.4. Click **"Zigbee Lighting"** on the left side of page and click **"Zigbee 3.0 Wired Gateway"**

5.5. Follow the APP instruction to complete configuration

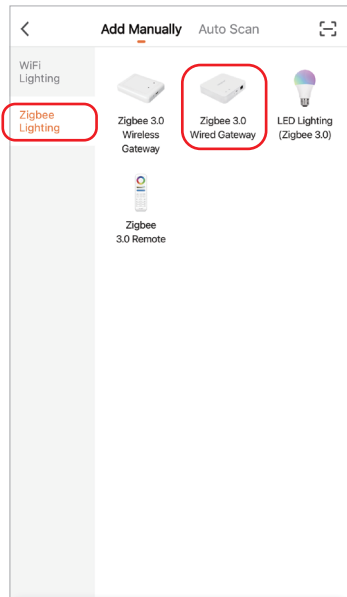

## 6. Add Zigbee sub-device

6.1. Click **"Zigbee Gateway"** on the home page of APP

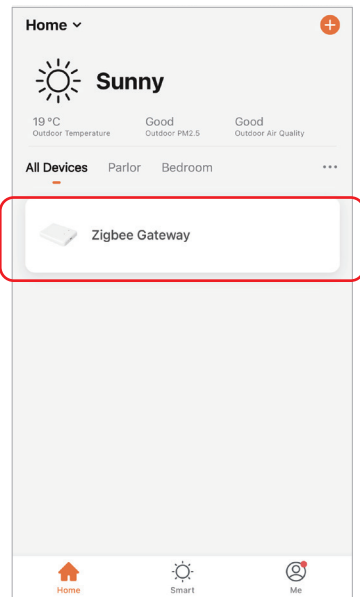

6.2. Click "Add sub-device" button and follow the APP instruction to complete device

6.3. Click  in the upper right corner to modify device name

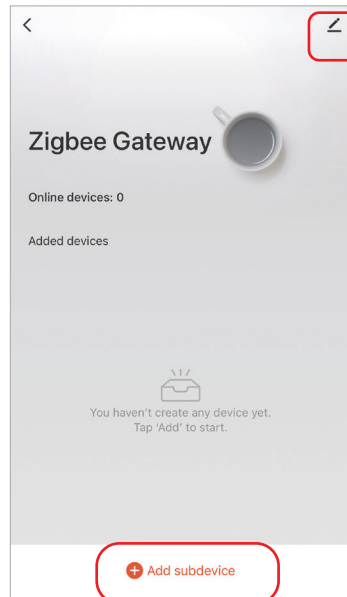

## 7. Support Amazon Alexa Control

Please search " Smart Life " skill in Alexa APP and activate the skill

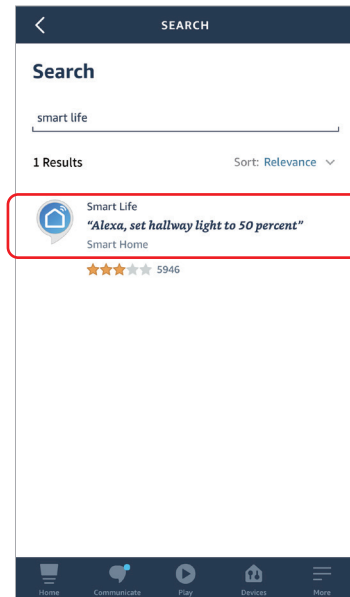

## 8. Support Google Home Control

Please search " Smart Life " skill in Google Home APP and activate the skill

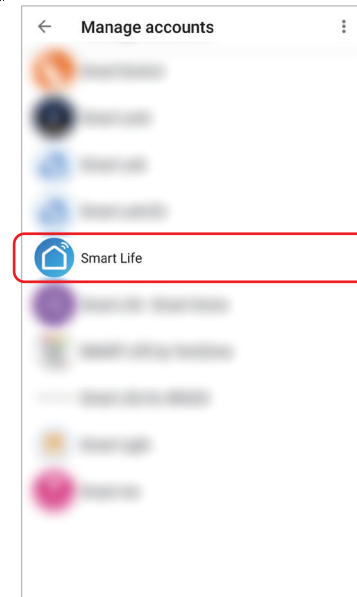

## 9. Warning

- 9.1. Keep equipment to stay away from strong magnetic field, otherwise it will affect control distance seriously.
- 9.2. Please do not install equipment in direct sunlight, humid or other high temperature area, working temperature is -10~40°C
- 9.3. Non-professional user cannot disassemble device directly, otherwise device may be damaged.



Scan QR code to watch video instruction



Made in China